



THE
NATIONAL
GALLERY

YOUR WEDDING AT
THE NATIONAL GALLERY

📞 +44 20 7747 5931 · ✉ venue.hire@nationalgallery.org.uk · 📱 @ngevents



THE GALLERY

It doesn't get any more 'London' than a wedding celebration in Trafalgar Square as Nelson looks on.

It doesn't get any grander than our 19th century building. And no other wedding venue in the city has masterpieces on its walls quite like ours.

We will set the stage for an evening that you and your guests will always remember.

THE PORTICO

Make your unforgettable entrance as you walk up the grand Portico steps onto the Portico Terrace, overlooking one of the most iconic views in central London – Nelson’s Column, Trafalgar Square, Big Ben and Westminster.

Standing 100

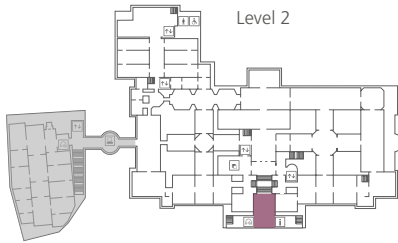

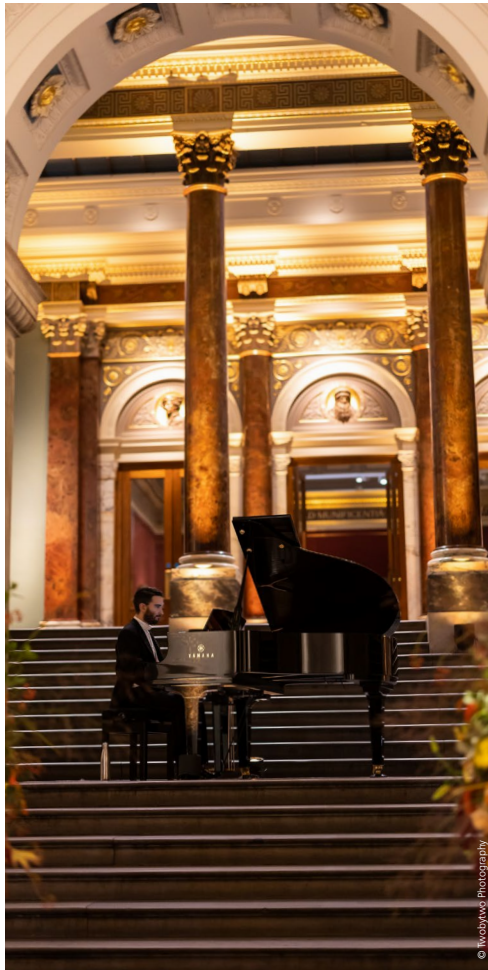
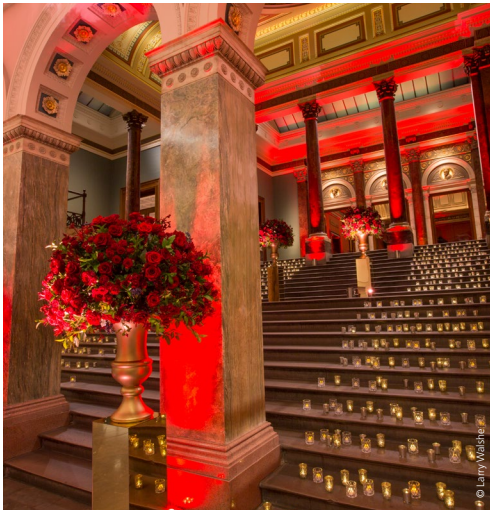

MOSAIC TERRACE

Let the enchanting Mosaic Terrace welcome you into the Gallery, with its domed ceiling and marble pillars. The intricate detail of love, compassion and glamour in the mosaics, including Seven Virtues, Awakening of the Muses, Virginia Wolf and Greta Garbo, will add to your very own love story.

Standing 100

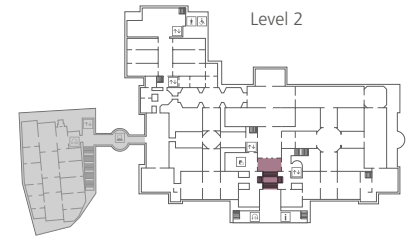

CENTRAL HALL

As you and your guests walk through the Central Hall, its beauty will set the tone for a memorable evening. Marked by boldly coloured walls and a majestic glass ceiling let yourself be transported into the charm of the National Gallery by incredible portraits from our collection.

Standing 200 · Seated 100

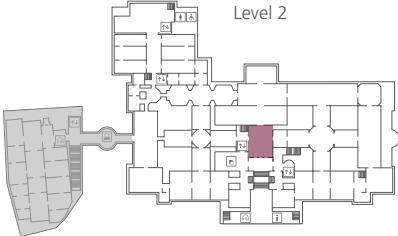



THE BARRY ROOMS

Some of the Gallery's most renowned art is waiting for you as you walk past the marble pillars into the Barry Rooms. Entertain your guests in the most architecturally impressive location in the Gallery and raise a toast under the breathtaking glass-domed ceiling.

Standing 300 · Seated 150

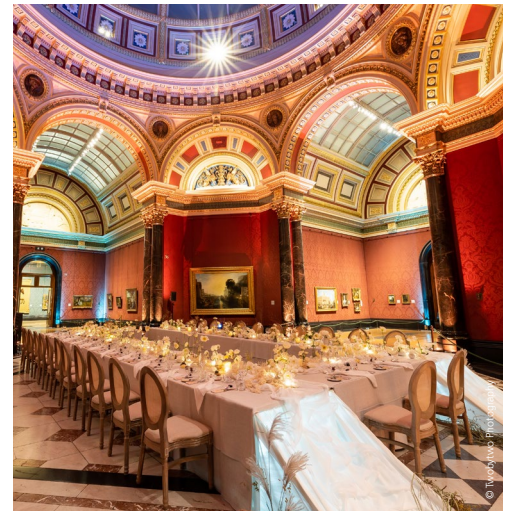
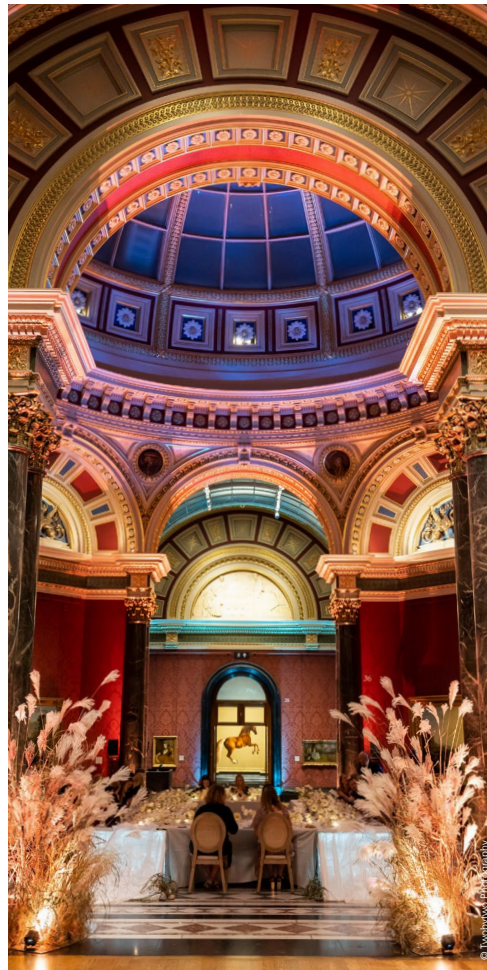
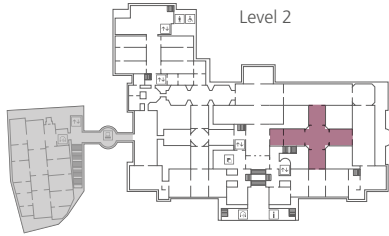



ROOM 32 THE JULIA AND HANS RAUSING ROOM

Continuing into the recently refurbished Room 32 from the Barry Rooms, you'll be transported to an Italian palazzo. Celebrate surrounded by world-renowned Italian Baroque masterpieces, including works by Caravaggio and Artemisia Gentileschi.

Standing 450 · Seated 300

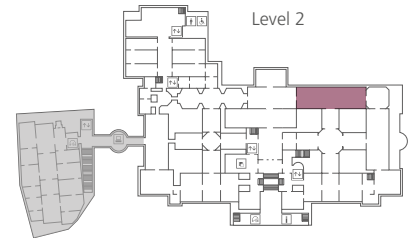

ROOM 34 THE BRITISH COLLECTION

Experience the splendour of 18th and 19th century British Society as you enter Room 34. The walls are adorned with exquisite shades of blue. These provide an elegant backdrop for your wedding celebration, as renowned artists like Turner, Constable, and Stubbs join your guestlist.

Standing 350 · Seated 270

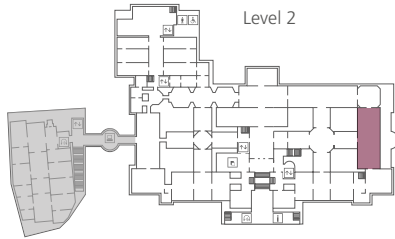

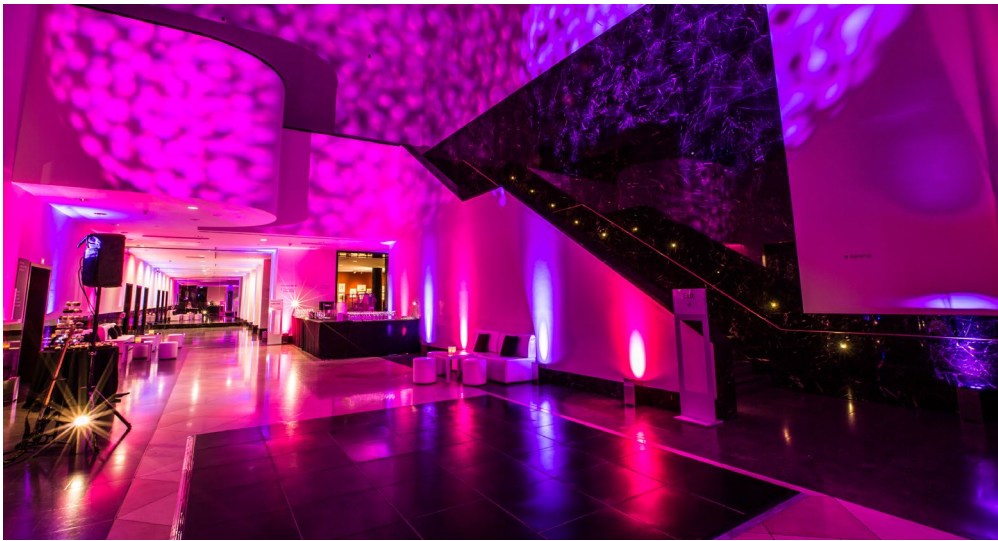

ANNENBERG COURT

After the wedding breakfast, there is always room for more celebration. Lead your guests to our contemporary Annenberg Court and make your next spectacular entrance down the sweeping staircase for your first dance. Continue to dance the night away until the early hours of the morning.

Standing 200

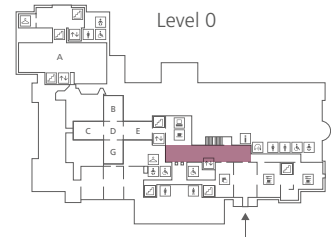



THE JULIA AND HANS RAUSING ROOM

FAQs

Do get in touch with our Venue Managers who will be happy to answer any other questions.

HOW MANY GUESTS CAN WE INVITE?

Our event spaces can host up to 300 guests (seated). Capacity can vary depending on the space of choice. Let our team guide you through the best options for your wedding celebration. These include an exciting after-party space, Annenberg Court, for up to 250 guests.

CAN WE PROVISIONALLY HOLD A DATE?

We can hold a date for your wedding celebration, free of charge and with no obligation, once you have booked a show around. We will then ask for confirmation by a certain date after your visit.

HOW DO WE CONFIRM OUR EVENT?

To confirm your event, we ask you to sign a copy of our venue hire contract and pay a 50% deposit. The balance amount is due two months before your wedding celebration day.

ARE YOU LICENSED FOR CIVIL CEREMONIES?

We are not licensed for wedding ceremonies, but there are several nearby venues that are. Alternatively, you can have a symbolic blessing, which does not require a license.

CAN WE USE OUR OWN SUPPLIERS?

To protect our spaces and the precious masterpieces they house, we ask you to choose from our hand-picked selection of trusted suppliers for your catering, lighting, flowers, entertainment and audio-visual requirements.

CAN WE SUPPLY OUR OWN DRINKS?

You are welcome to bring your own drinks and need to communicate that directly with your catering company of choice. They may charge to chill, deliver and serve your drinks.

WHAT IS THE FEE?

Prices start from £18,000 +VAT.

CAN WE USE THE GALLERIES FOR OUR WEDDING PHOTOS?

Yes, there are plenty of wonderful locations for photo shoots. We are happy to share suggestions ahead of the special day.

CAN WE HAVE CONFETTI IN THE GALLERY?

You can have confetti outside the building, but it cannot be used inside the building. This includes paper, petal, rice, bubbles and sparklers.

CAN WE HAVE CANDLES IN THE GALLERY?

We can't light candles inside the Gallery, but your suppliers of choice can suggest alternative options and effects.

WHAT TIME DO WE HAVE ACCESS TO THE BUILDING?

The National Gallery is open to the public until 6pm. Suppliers have access to set up from 6pm with guest arrival from 6.30/6.45pm. This allows the suppliers time to set the scene before it all begins.

WHAT IS INCLUDED IN THE VENUE HIRE FEE?

The fee includes exclusive use of the agreed event spaces, a dedicated event manager, security staff and cleaning.

DO I NEED INSURANCE?

Yes. As your wedding celebration will take place in a Grade I listed building with priceless masterpieces, you will need to have Public Liability Insurance. Most insurance companies offer the minimum cover of £10 million, at a small cost.

DO I NEED A WEDDING COORDINATOR OR PLANNER?

We strongly recommend having an expert on hand to help plan your special day. We are happy to share with you our selection of preferred planners, or you can choose your own.



ACCREDITED SUPPLIERS

When the doors close at 6pm, it's time to transform the Gallery into the perfect setting for your wedding celebration. From sumptuous catering to immersive experiences, our handpicked suppliers include caterers, florists, production companies and entertainment companies.

Explore our supplier options [here](#).



AN ICONIC LANDMARK & LOCATION

We are only 5 minutes from Leicester Square or Charing Cross stations and local drop off points. Other local, photogenic locations include Buckingham Palace, The Mall, St James's Park, St James's Palace, Westminster Bridge, Palace of Westminster, Big Ben, Green Park and Piccadilly Circus.



Step-free access is available via the Getty entrance.

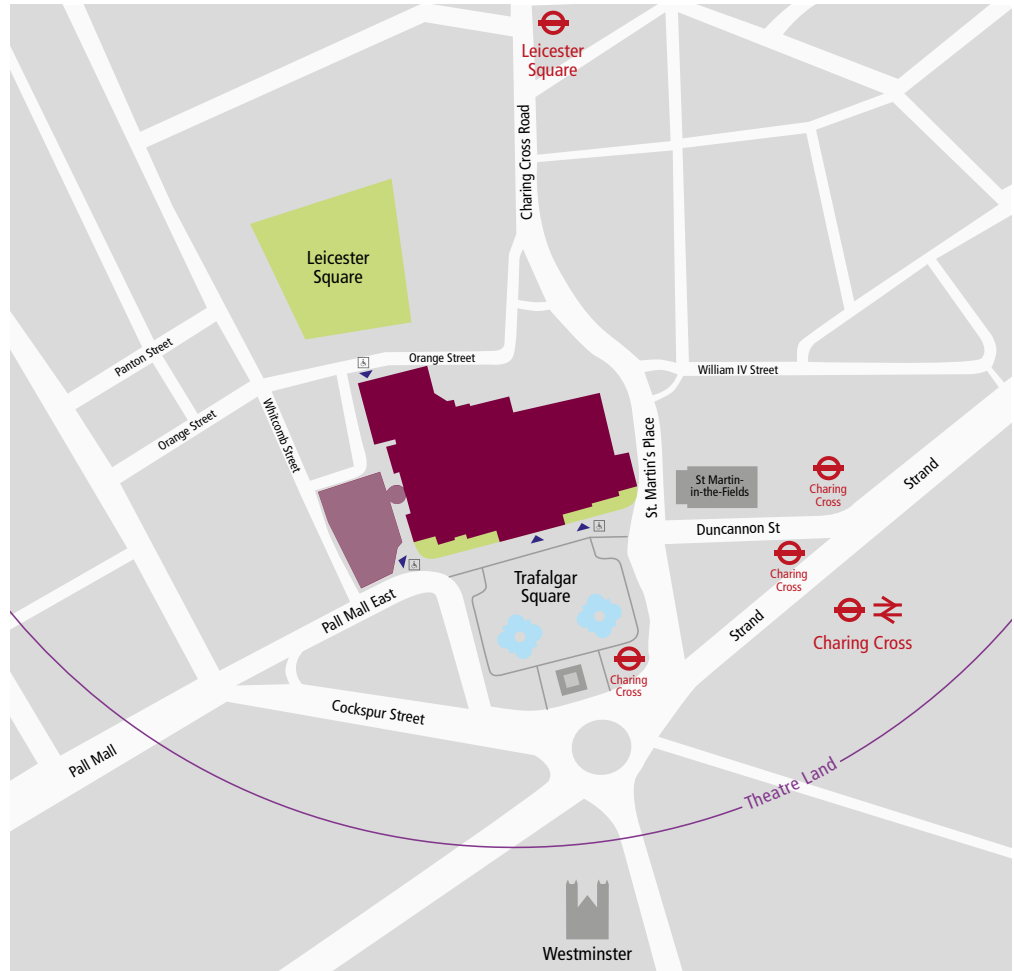



THE NATIONAL GALLERY

Our Events Team looks forward to helping you turn your dream wedding into a reality. Contact us to start the journey!

Your booking generates valuable revenue for the Gallery to ensure that future generations can enjoy the paintings as we do today. Thank you.

📞 +44 20 7747 5931

✉️ venue.hire@nationalgallery.org.uk

📷 @ngevents

© The National Gallery, London. National Gallery Global Limited, London.

nationalgallery.org.uk/venue-hire

